



## Rating valuation

Property details	
Street address	54 Ballantyne Way, Angatete
Valuation reference	6808/28664
Property ID (QPID)	2505458
Territorial authority	Western Bop District (22)
Owner/occupier	Not available
Outstanding activity	No
Nature of improvements	
Category	Residential-Vacant Site

Rating value data	
Capital value	\$310,000
Land value	\$310,000
Value of improvements	\$0
Rating value date	01/07/2008

Legal information	
Certificate of title	117353
Legal description	Lot 126 DP 328738
Tenure	Not Leased (Owner is Occupier)
Ownership	Individual
Rateability	Rateable

Land use information	
Zone	1C
Use	Vacant Residential
Units	1
Carparks	
Maori land	No
Building age	
Wall construction	
Roof construction	
Land area	.0863 Ha
Floor area	
Site	0 m <sup>2</sup>

## Map

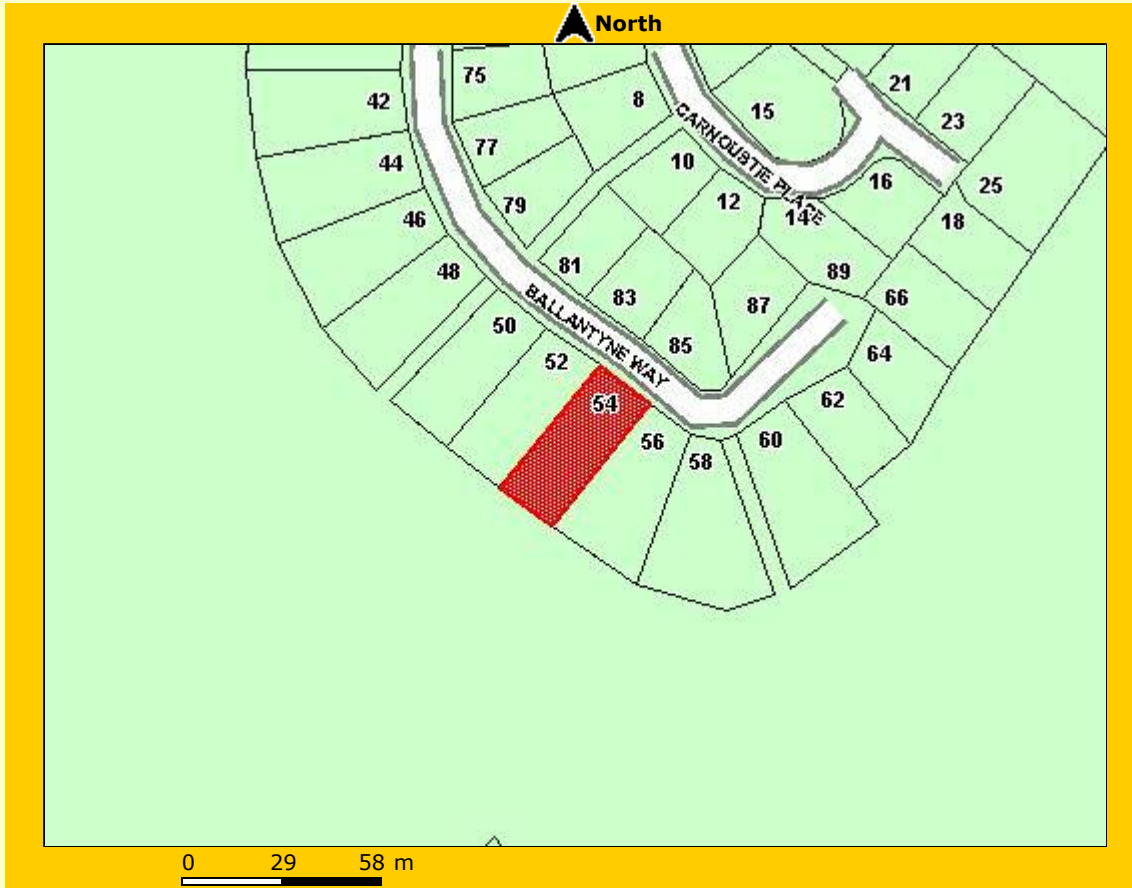

## Map legend

23 Address Point	★ Landmark	⚡ Monument	□ Pylon
● Railway Station	⚓ Tower	— Powerline	▭ Parcel
■ Park	■ Shopping Centre		

## Property Offers



Save up to 20%  
on your life  
insurance.



Visit Mitre10 for  
home improvement  
tips and tricks

## Disclaimer

The rating valuation data contained in this report is the result of data collated by PropertyIQ NZ Ltd (PropertyIQ).

The valuation data is not intended or designed to replace a Full Registered Valuation. If you need a property valuation for lending, tax or other purposes then you should seek a full valuation from a registered valuer.

Any map showing property boundaries is indicative only and may not be complete or accurate. Any map that is produced is not intended or designed to replace the Certificate of Title or land survey information. If you need a Certificate of Title or land survey information for any purpose then you can order these from [qv.co.nz](http://qv.co.nz). While PropertyIQ NZ Ltd (PropertyIQ) has used reasonable endeavours to ensure the accuracy, availability and completeness of the information contained in the map, this is not

guaranteed by PropertyIQ.

A Rating Valuation Report is complete without a map.

PropertyIQ accepts no liability or responsibility for any loss or damage suffered by any person which may directly or indirectly result from any person acting on or refraining from acting as a result of the rating valuation data or the map information.

qv.co.nz is owned and operated by PropertyIQ NZ Ltd - a joint venture between Quotable Value Limited and RP Data Limited.



[www.qv.co.nz](http://www.qv.co.nz)

*All rights reserved, ©Copyright Quotable Value Limited, 1999-2009*